

September 22, 2008

NEW!

Leigh Hold-Down Clamps



Bench Hold-Down Clamp

Leigh Industries, a leader in joinery jig technology, announces two new hold-down clamps for general woodworking and custom jigs & fixtures.

The clamp technology, developed for the award winning Leigh Dovetail Jig and the incomparable Leigh FMT, has a long history of reliable use. These clamps are tough and versatile with immense holding power.

Two models are available. Please read on to learn more.



Surface Hold-Down Clamp

Leigh Bench Hold-Down Clamp (BHDC1)



Leigh Bench Hold-Down Clamps provide exceptional holding power and that “extra hand” you need for many tasks in the shop. These clamps were designed to be used in the 3/4" bench dog holes found in most work benches. The long 3/8" threaded rod and speed nut allow the clamp to be used in benches up to 4 1/4" thick.

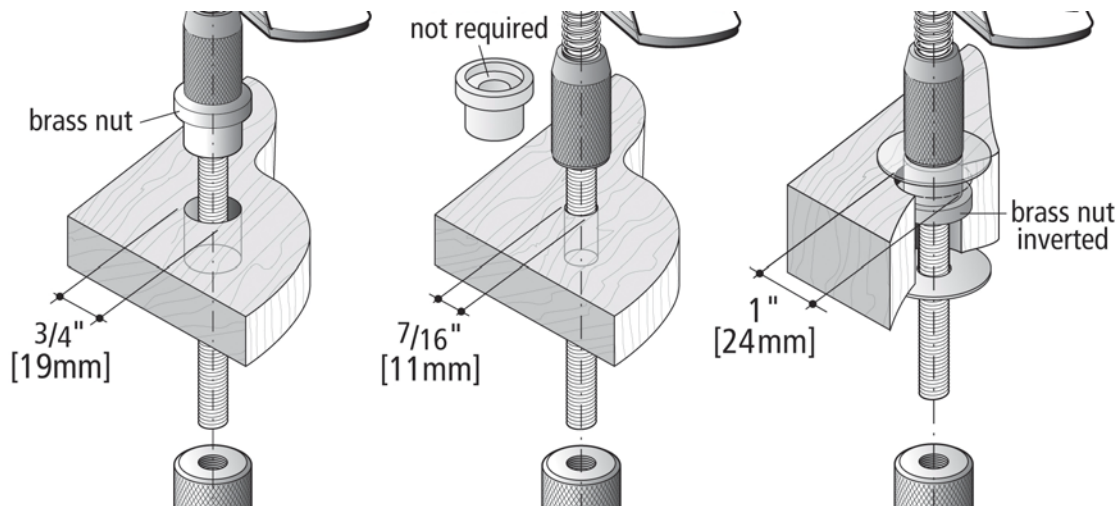

Alternatively, the unique design of the included threaded brass nut allows the Bench Clamp to be used in any size hole from 7/16" to 1 1/8" and on any flat surface. You can even mount them vertically!

No holes, no problem! Simply drill 7/16" or larger holes through your bench or work surface at the desired location, remove the small brass nut, add the supplied fender washers and tighten the speed nut. If you need a second clamp, just use/drill another bench hole or use a Surface Hold-Down Clamp and clamp anchor.

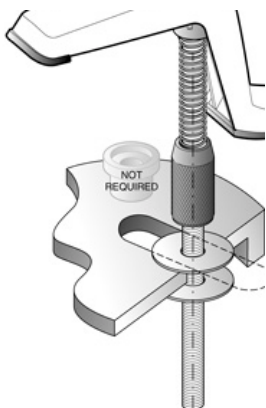

How many times have you held a work piece in one hand, on a drill press table, while advancing the drill with the other, only to have the drill bit catch in the work piece and tear it out of your hand?

The Bench Hold-Down Clamp attaches easily to most drill press tables providing safe and secure clamping. Once again, just remove the brass nut and add the fender washers top and bottom. No more damaged work pieces.....or hands!

Leigh Hold-Down Clamps
Legendary Leigh Quality, Precision, Versatility and Performance

Leigh Surface Hold-down Clamp (SHDC1)

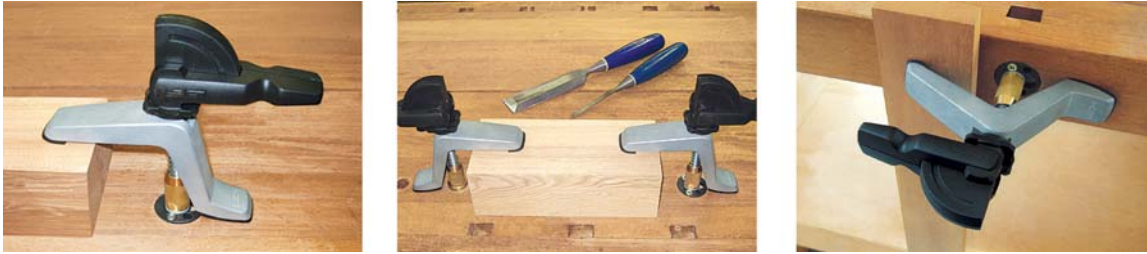

No holes! No problem!! The Surface Hold-Down Clamp can be mounted wherever that “third hand” is needed. Like the Bench Clamp, the Surface Clamp mounts on any flat surface and at any angle. Use them anywhere on the top of your workbench or mount them vertically on the side of the bench or....use a combination of Surface Clamps and Bench Clamps together.

The Surface Mount Clamp is great for shop made jigs and fixtures such as table saw sleds or router table jigs. Use the optional T-Track mounting method for completely adjustable clamp positioning.

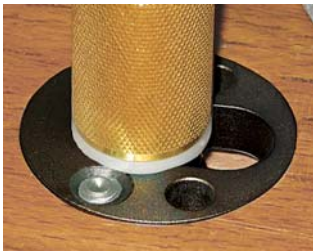

The simple design of the Surface Clamp Anchor makes mounting easy and fast. Just use a Forstner (or equivalent) bit to make a 1 1/2” hole, 5/16” deep wherever a clamp is needed.

Position additional anchors wherever you need them. Two anchors are packaged with every clamp and additional anchors are available in a 4-pack. One clamp. Multiple Clamp positions!

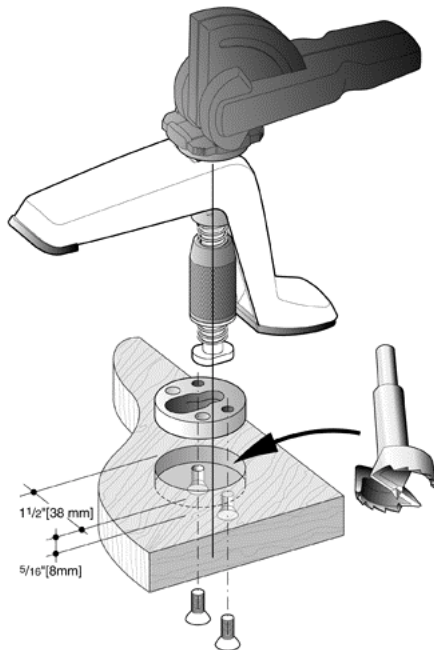

The large holes in the anchor act as drill guides. Just position the large holes where you want the center line of the clamp and drill two 9/32” holes. Rotate the anchor 180 degrees and use two 1/4” - 20 machine screws from the bottom of the bench to hold the anchor securely.

If your bench is too thick or inaccessible, use two #8 wood screws through the top of the anchor and in to the bench.



Leigh Bench Hold-Down Clamps Leigh Surface Hold-Down Clamps

Features

Both Clamps Share These Features

- Proven cam action technology (D4R and FMT)
- Enormous clamping strength – greater than ordinary bench clamps
- Made from tough glass filled nylon
- Quick 90 degree clamp action
- Clamp Arm made from ZA-12 alloy for superior strength
- Non marring heel and toe
- Infinitely adjustable clamping from 0.00” to 3.00”
- Mount on *any* flat surface
- Horizontal or vertical mounting
- 5 year warranty

Surface Hold-Down Clamp Features

- Permanent inset clamp anchor – the anchor mounts flush with the work surface so there is no need to remove it when the clamp is not in use.
- Multiple clamp positions using additional anchors
- Additional anchors available (4 pack)
- Surface mount clamp works with some common “T” track
- Common 1/4-20 thread anchor screws (included)
- Common 3/8-16 thread T-bolt

Bench Hold-Down Clamp

- Bench mount does not damage dog hole
- Clamp attaches quickly with Speed Nut
- Works with standard 3/4” bench dog holes or any bench hole from 7/16” to 1 1/8”
- Fender washers included for larger hole mounting
- Common 3/8-16 thread **speed nut**

Packaging

- Tough secure clam shell packaging – great for storing the clamps between uses
- See through design
- Instructions on card
- Bench Anchors - 4 pack in poly bag

Pricing

		MSRP USA & Canada
SHDC1	Leigh Surface Hold-Down Clamp	\$49.95
BHDC1	Leigh Bench Hold-Down Clamp	\$49.95
SHDCA	Bench Anchors (4 pack)	\$19.95

Leigh Hold-Down Clamps
Legendary Leigh Quality, Precision, Versatility and Performance